







## PARC 05

Parc is a collection inspired by childhood imagination and the essentiality of homemade forms — created in collaboration with Swiss designer Adrien Rovero. Evoking the archetype of a flashlight, each lamp of the Parc Collection is a playful reminder of time spent in nature, when a simple tube and piece of string could be used to fashion any number of creations. These makeshift things, at once naive and functional, harness the unique beauty of peeling an object back to its essence.

<b>type:</b>	floor
<b>construction:</b>	hand blown frosted glass powder coated aluminum body vinyl cord
<b>specifications:</b>	source: LED lamp provided (G9 base) power consumption: 3x 4,5W lumen output: 957lm colour temperature: 2700K included *3000K available upon request colour rendering index: 80 CRI standard * ≥ 90 CRI upon request expected lifetime: 25 000h
<b>control:</b>	refer to our recommended list of dimmer models
<b>cord length:</b>	132" / 335 cm foot switch at 60" / 152 cm from lamp
<b>weight:</b>	29.7lb / 13.5kg
<b>certifications:</b>	    IP20
<b>warranty:</b>	2 years

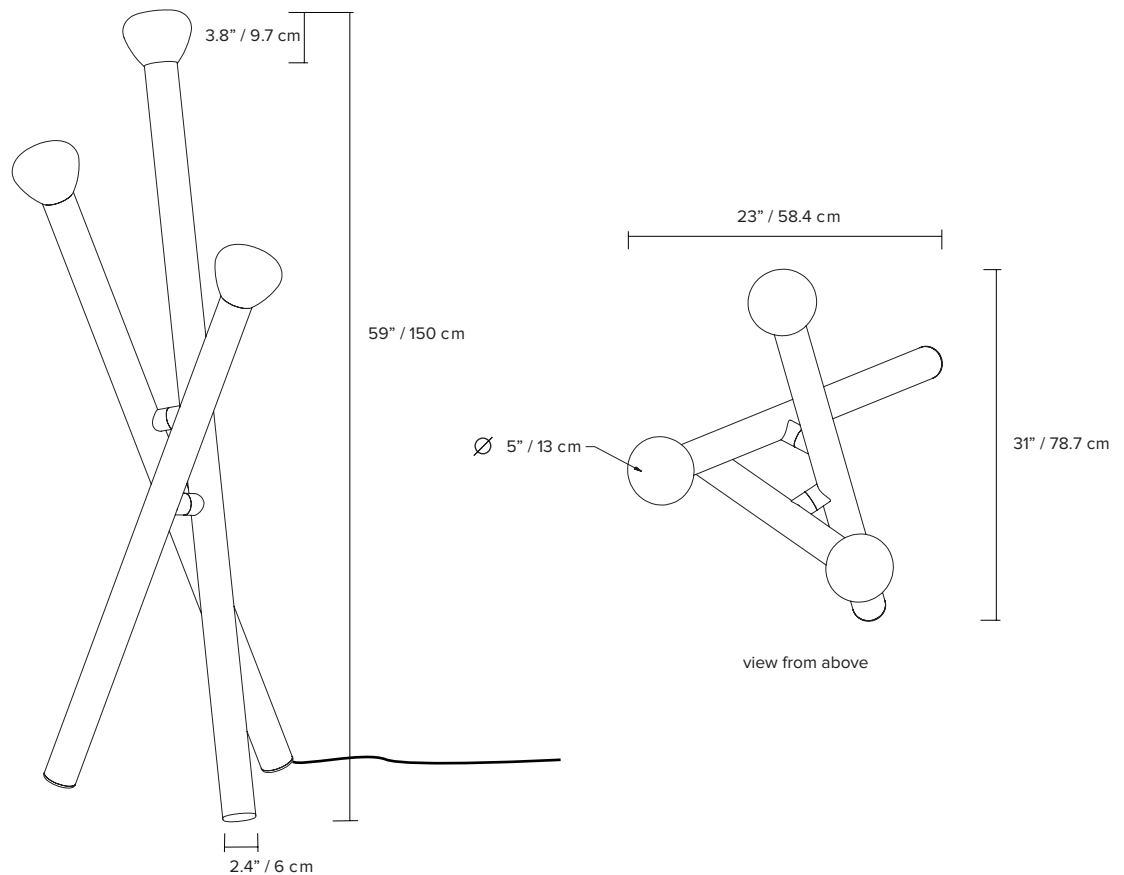

\*dimensions are approximate and may vary slightly

## ORDER GUIDE: SKU

COLLECTION	MODEL	BODY	CORD
PRC parc	05	BK black	BK black
		MB midnight blue	WH white
		BE blue	
		WH white	
		BG beige	
		BU burgundy	
		GN green	
		TC terracotta	
PRC	05	BK	BK = PRC05BKBK example

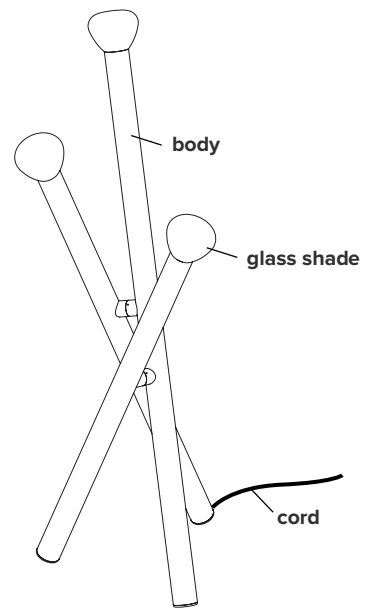

### FINISH (\*polyester cords also available in all colours upon request, except terracotta)

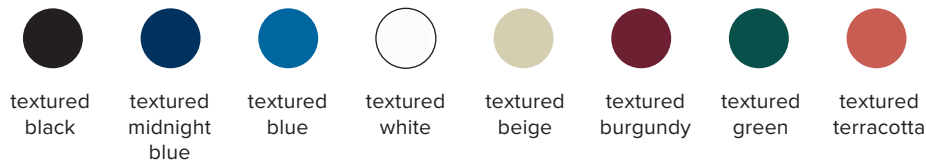

\* cords only available in black or white in Australia

### NOTES:

- must be installed by an electrician
- not protected against liquids (refer to IP20)
- additional charges for modifications or for special orders
- please refer to maintenance sheet on website for cleaning instructions

## EU ENERGY LABEL

